



# HANDPRINT TRACING COVER SHEET

DATE OF EVENT:

SCHOOL/GROUP:

TEACHER NAME:

NUMBER OF STUDENTS:

Bring to The Sawdust Factory or Upload at: [www.thesawdustfactory.com/handprintupload](http://www.thesawdustfactory.com/handprintupload)

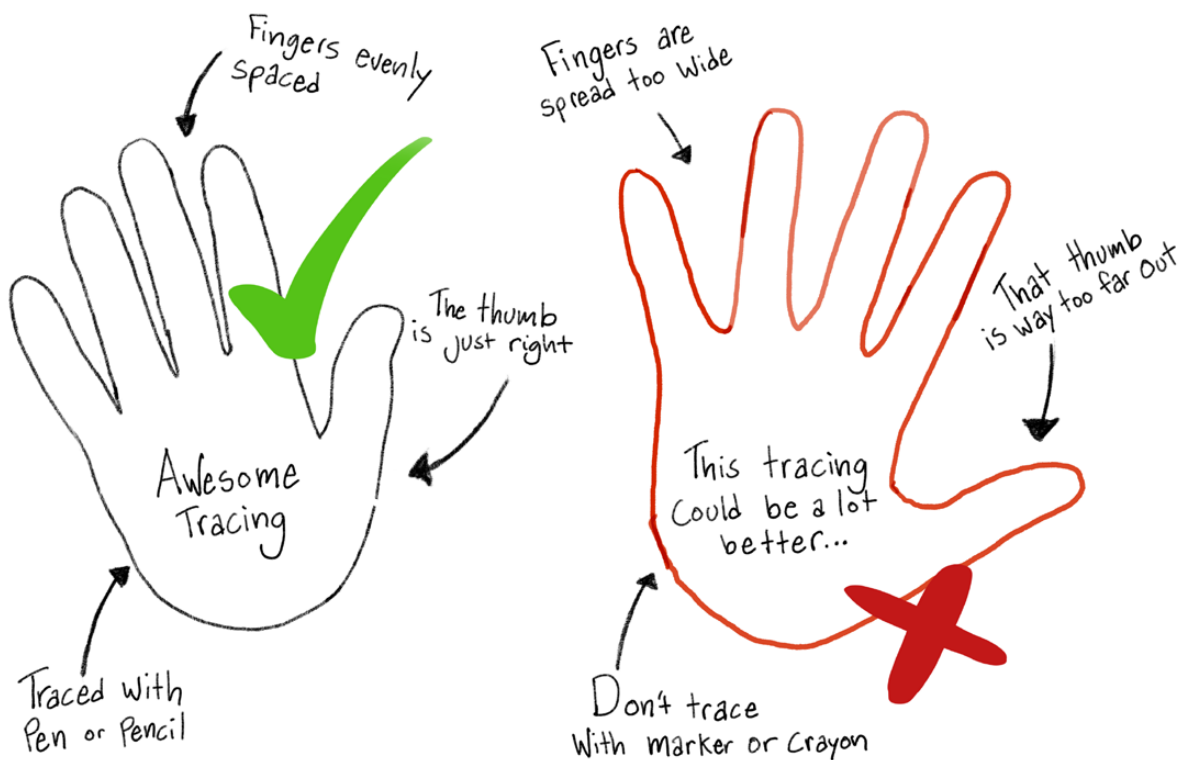

**IMPORTANT! If you are uploading be sure this line is 6 inches long**

- Please include a CLASS ROSTER with a copy of this cover sheet for each class.
- Write only first name of student unless there is another student with the same first name.
- Use regular 8x5x11 printer paper
- Trace hand-prints with pen (NO MARKER/CRAYON)
- Thumb should NOT be spread out far from fingers.
- Only one hand tracing needed per child. (left hand preferred)
- Write name of child legibly on each sheet next to handprint
- We will charge for all hand-prints that are cut out, even if student is absent

NOTES: